

29-05-001 , Engine Control 2,9 I V6 12V EFI , Ignition

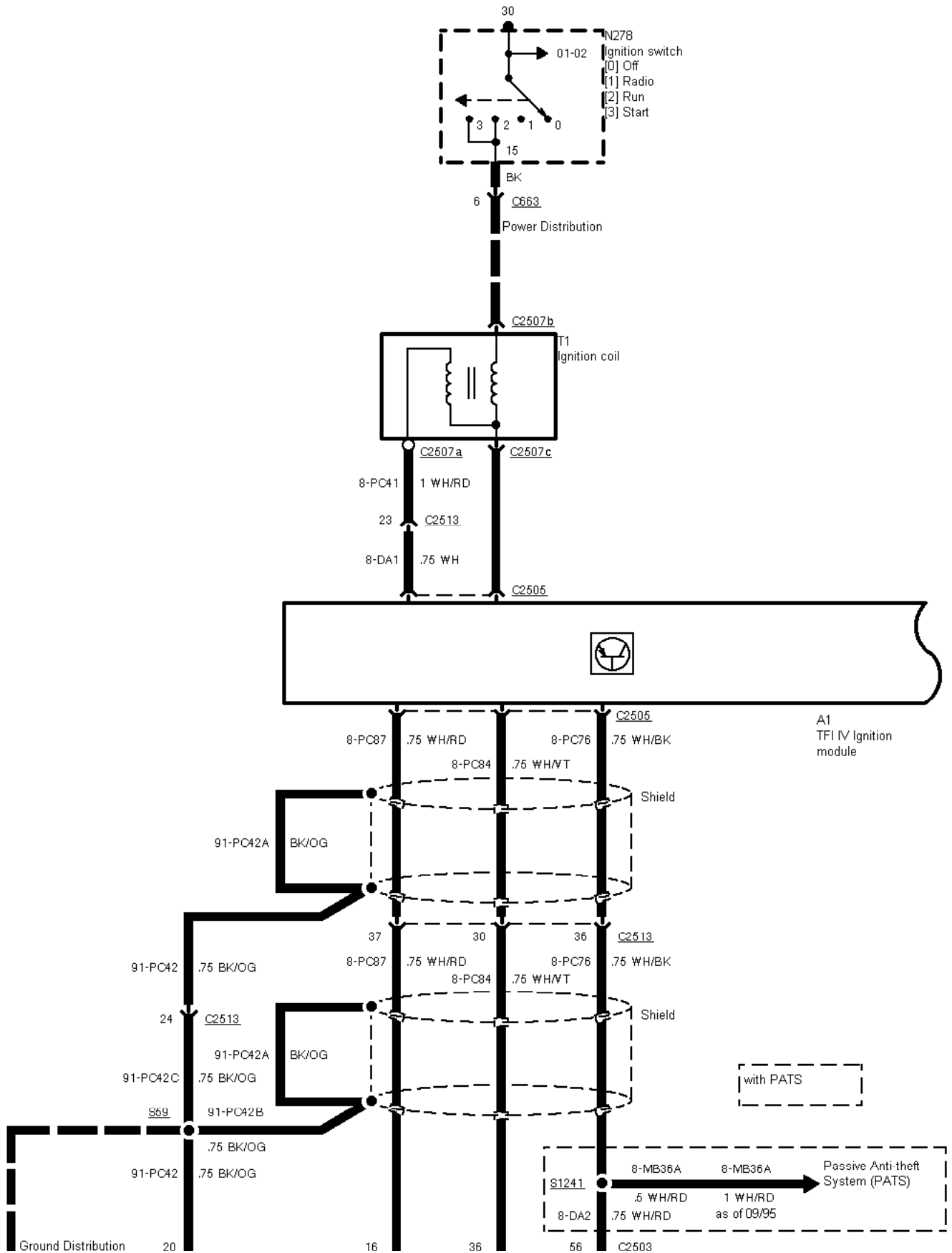

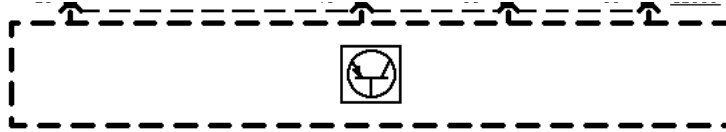
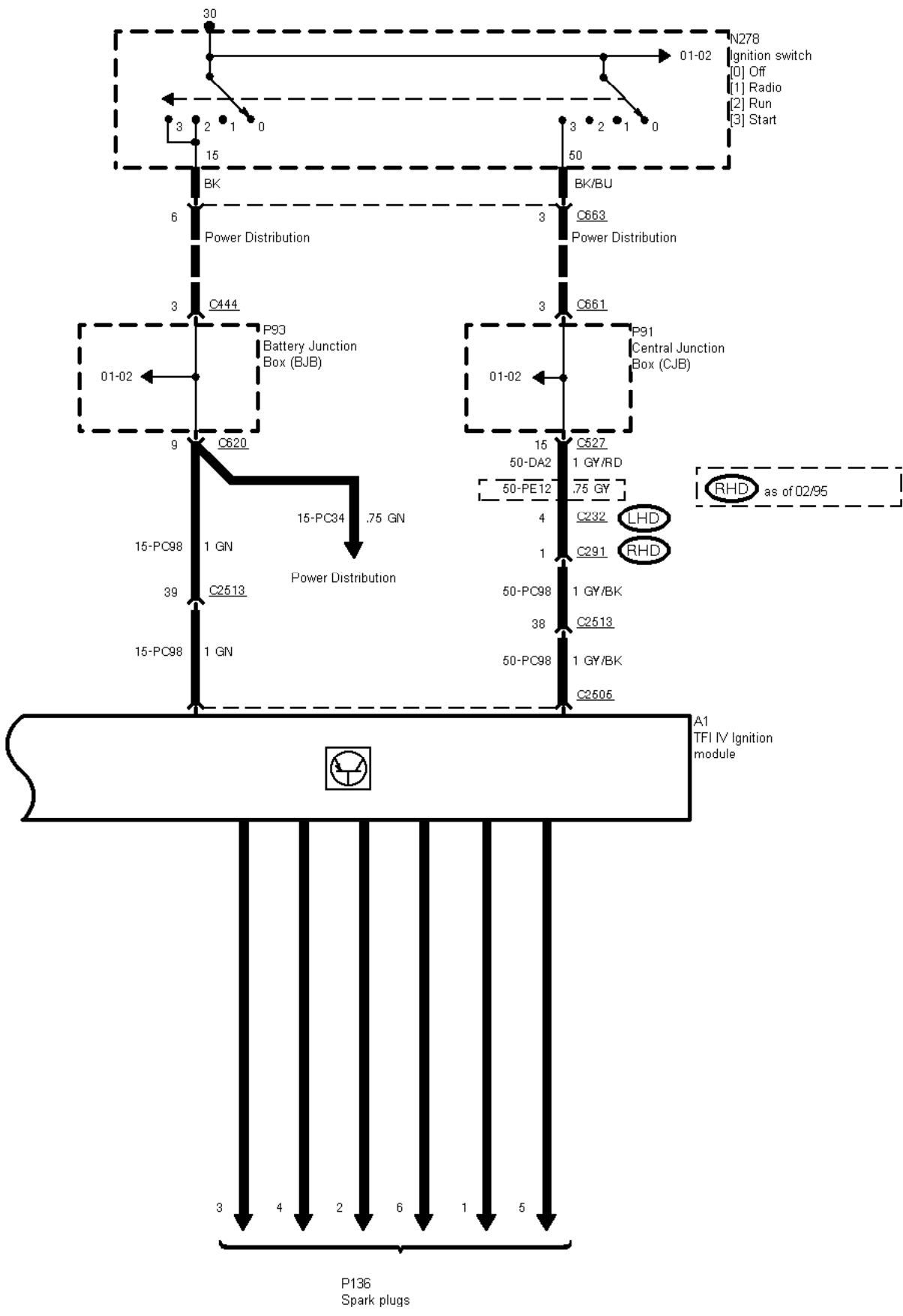

A147
Powertrain control
module (PCM)

29-05-002 , Engine Control 2,9 I V6 12V EFI , Ignition



29-05-003 , Engine Control 2,9 I V6 12V EFI , Fuel injectors

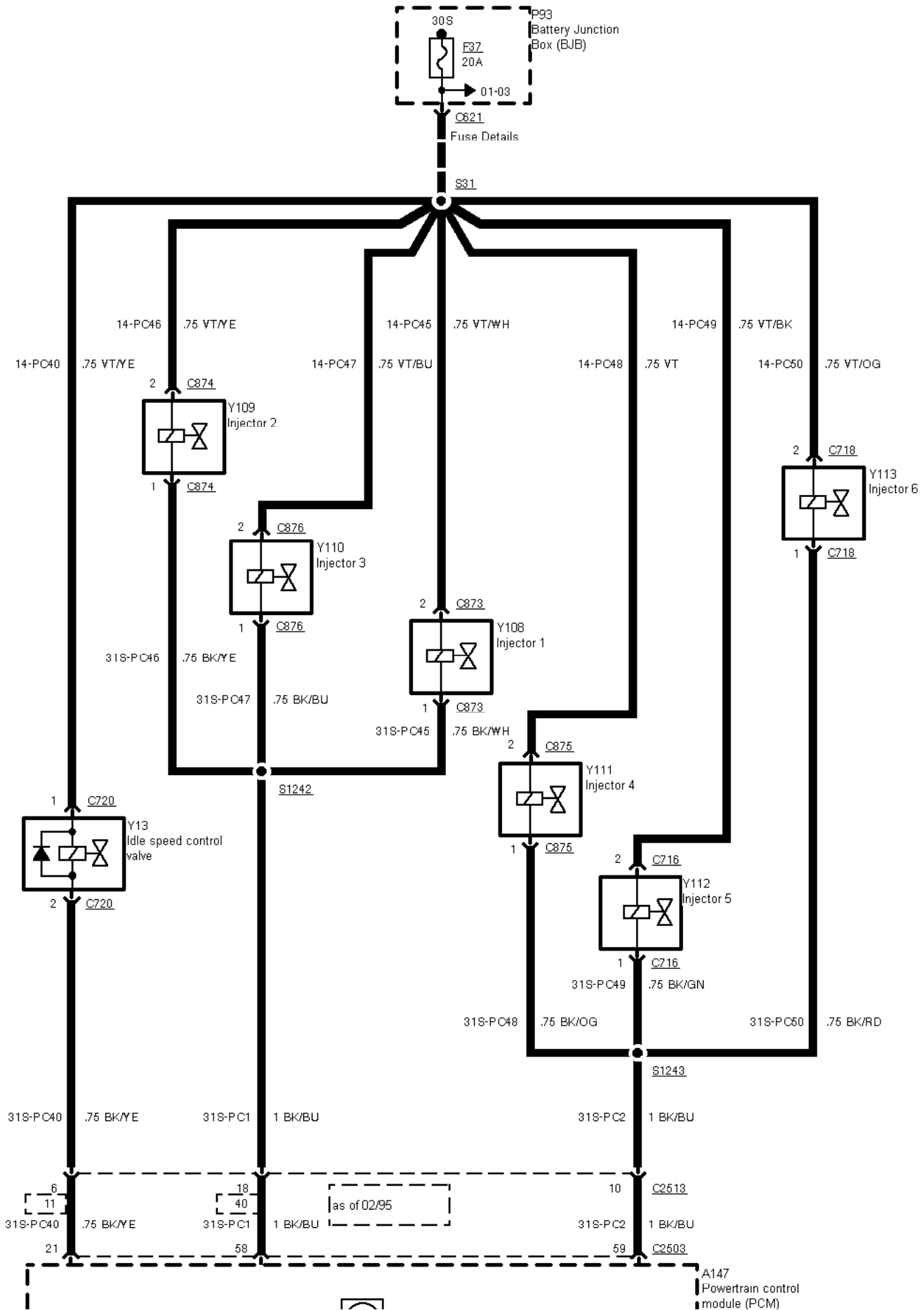



29-05-004 , Engine Control 2,9 I V6 12V EFI , Sensors, before 02/95

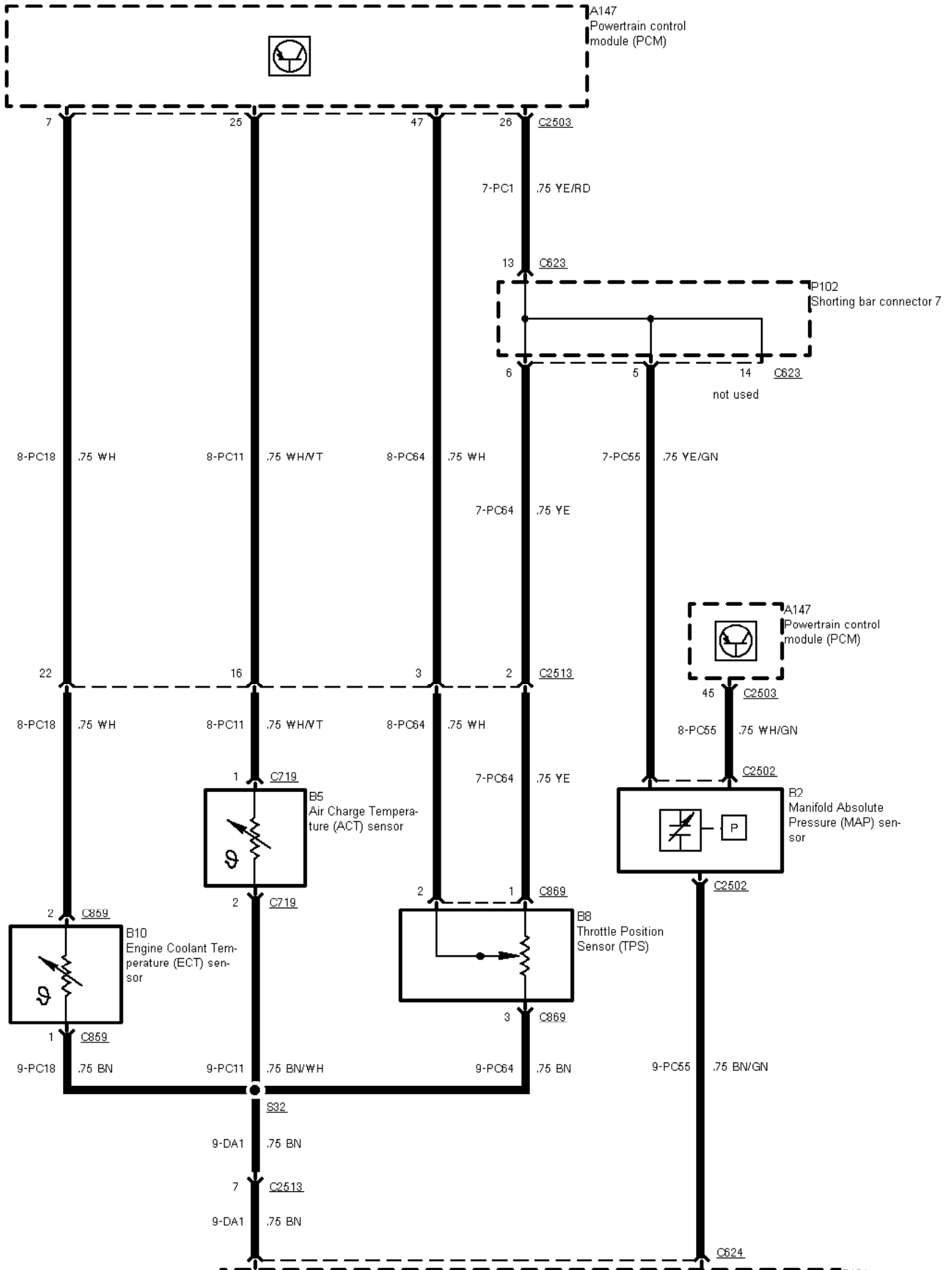

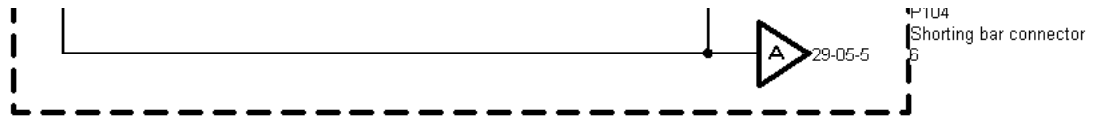

29-05-005 , Engine Control 2,9 I V6 12V EFI , Before 02/95

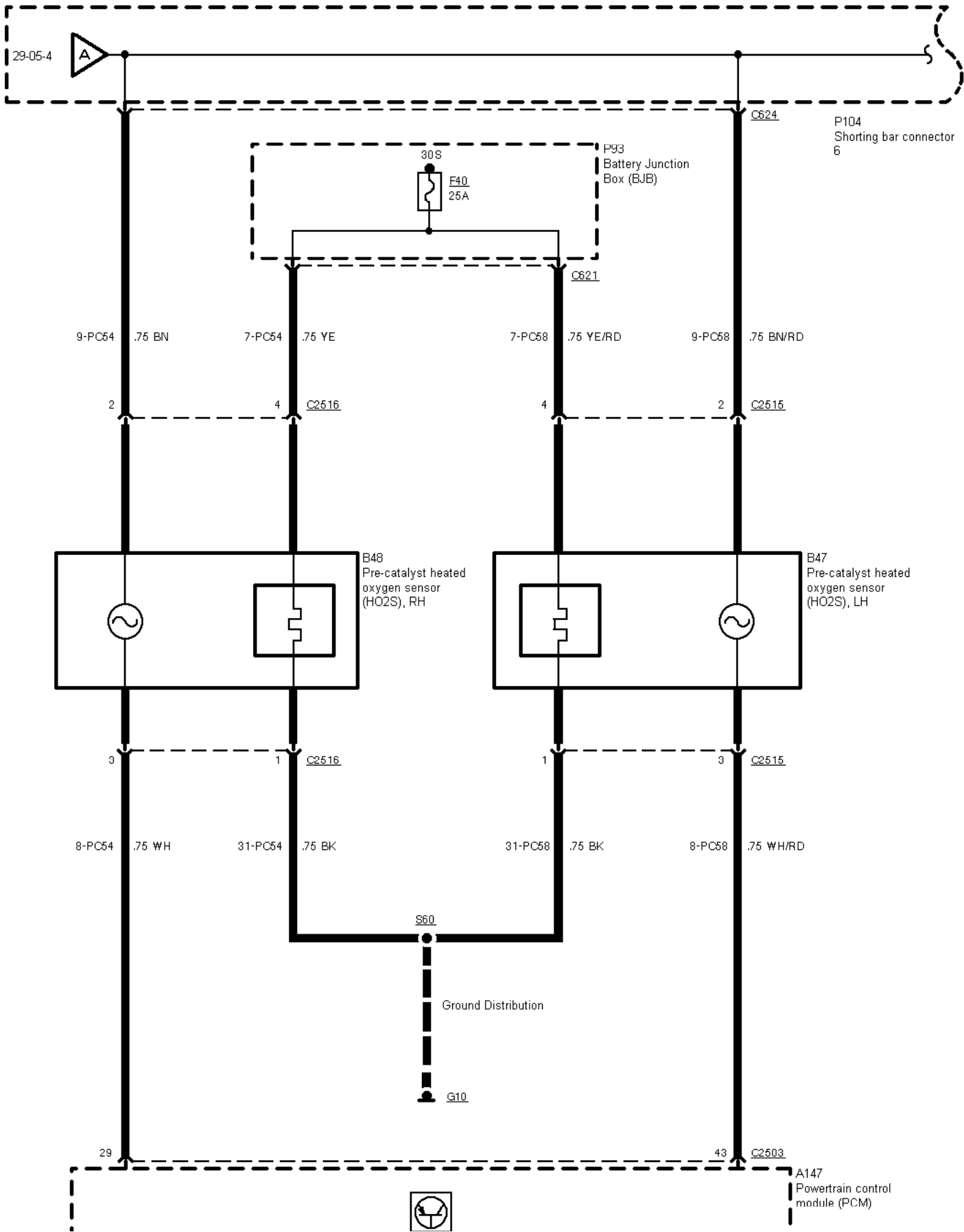

29-05-4



C624

P104 Shorting bar connector 6

P93 Battery Junction Box (BJB)



30S

F40 25A

C621

9-PC54 .75 BN

7-PC54 .75 YE

7-PC58 .75 YE/RD

9-PC58 .75 BN/RD

2

4

C2516

4

2

C2515

B48 Pre-catalyst heated oxygen sensor (HO2S), RH

B47 Pre-catalyst heated oxygen sensor (HO2S), LH

3

1

C2516

1

3

C2515

8-PC54 .75 WH

31-PC54 .75 BK

31-PC58 .75 BK

8-PC58 .75 WH/RD

S60

Ground Distribution

G10

29

43

C2503

A147 Powertrain control module (PCM)



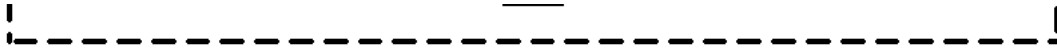

29-05-006 , Engine Control 2,9 I V6 12V EFI

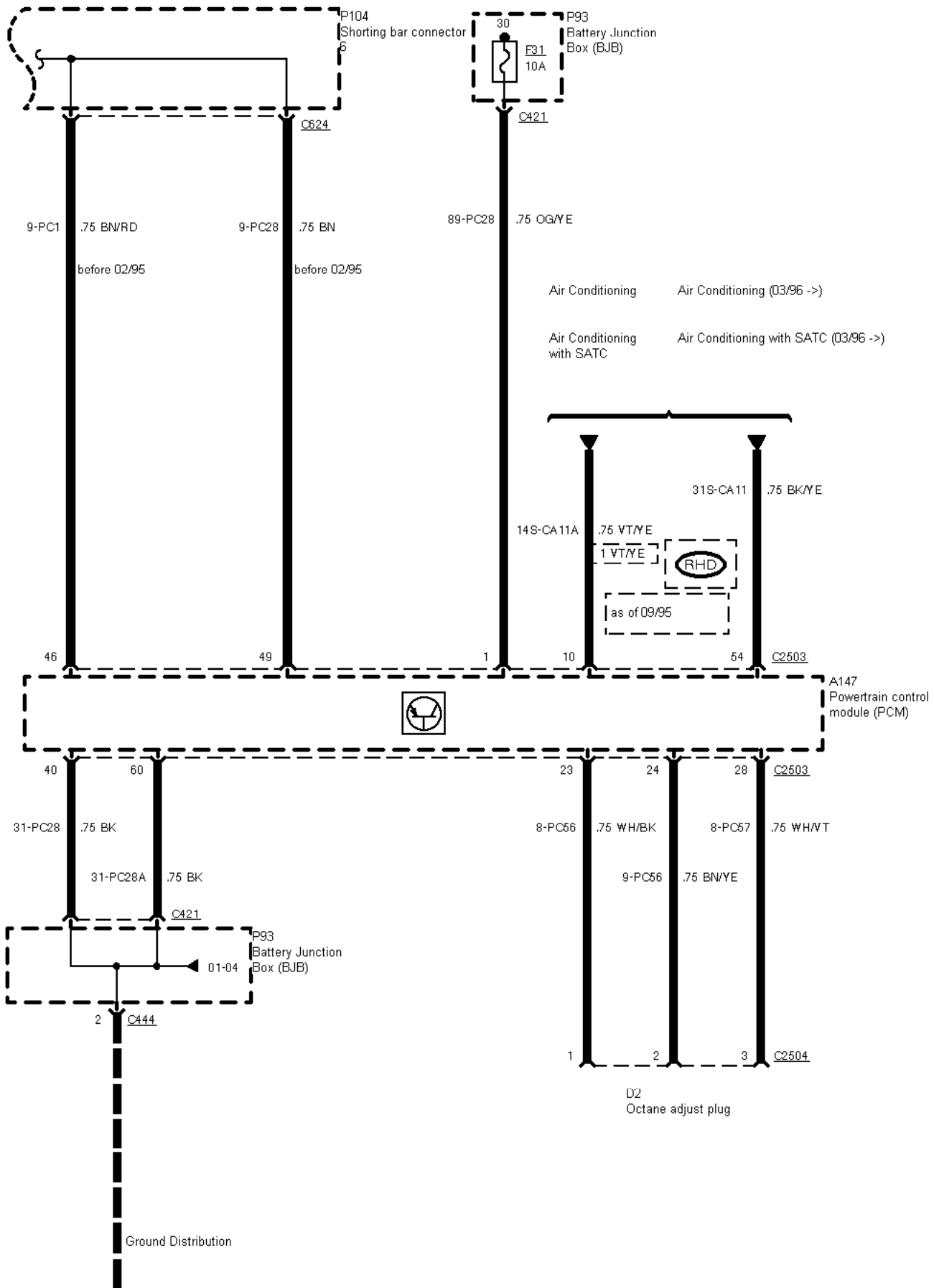



29-05-007 , Engine Control 2,9 I V6 12V EFI , Sensors, as of 02/95

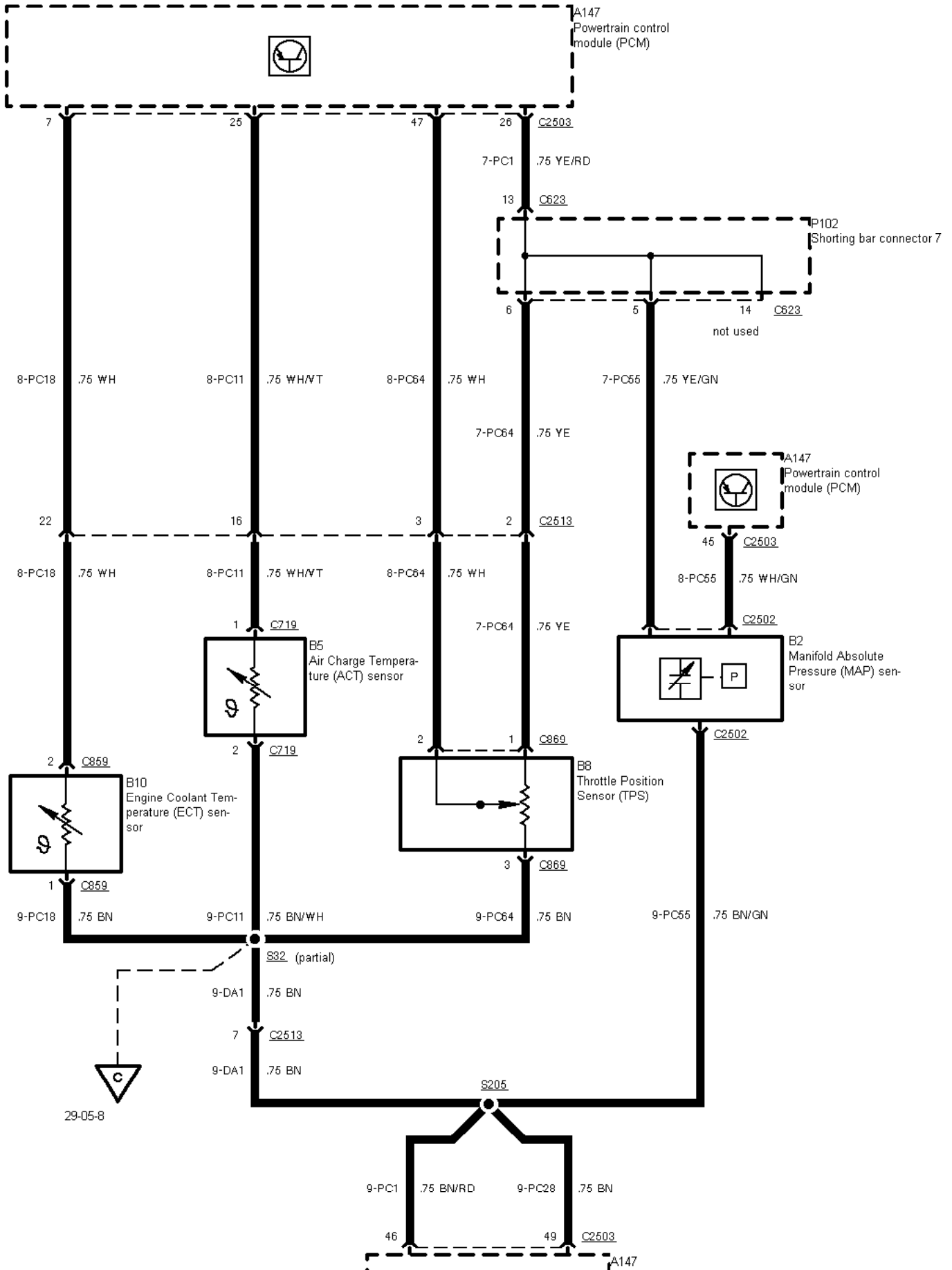



29-05-008 , Engine Control 2,9 I V6 12V EFI , As of 02/95

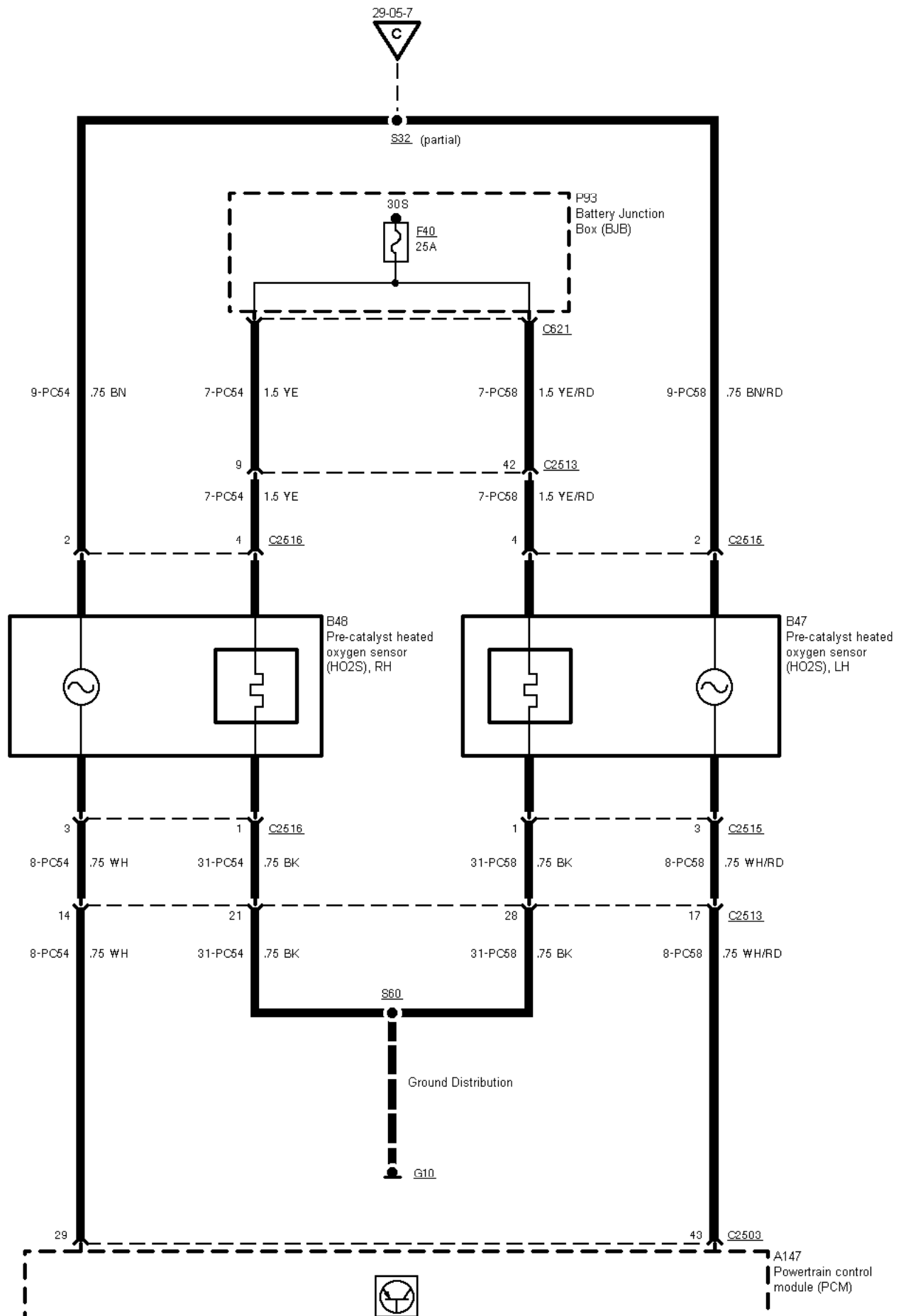

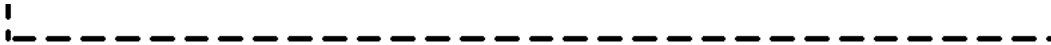

29-05-009 , Engine Control 2,9 I V6 12V EFI

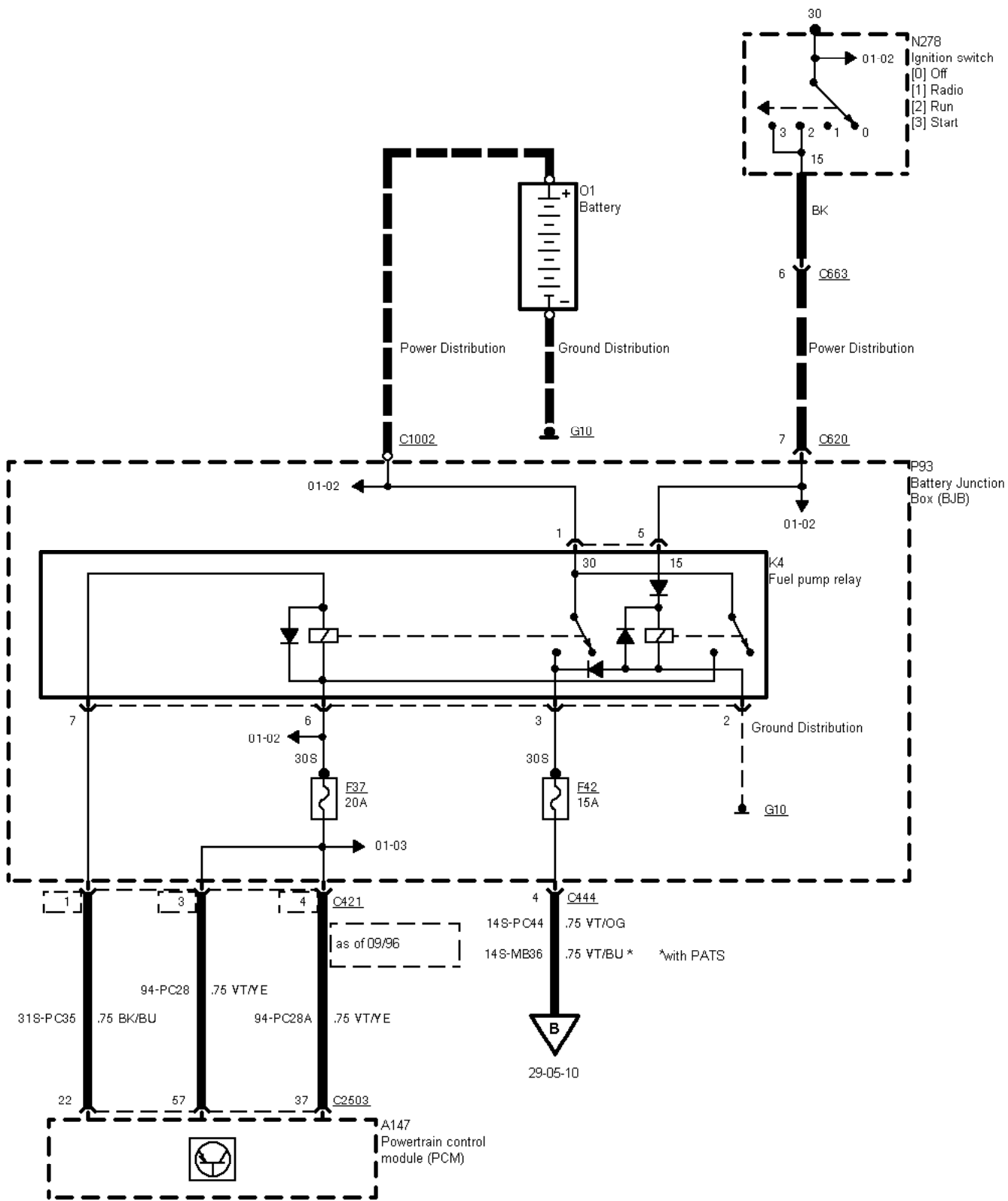

29-05-010 , Engine Control 2,9 I V6 12V EFI

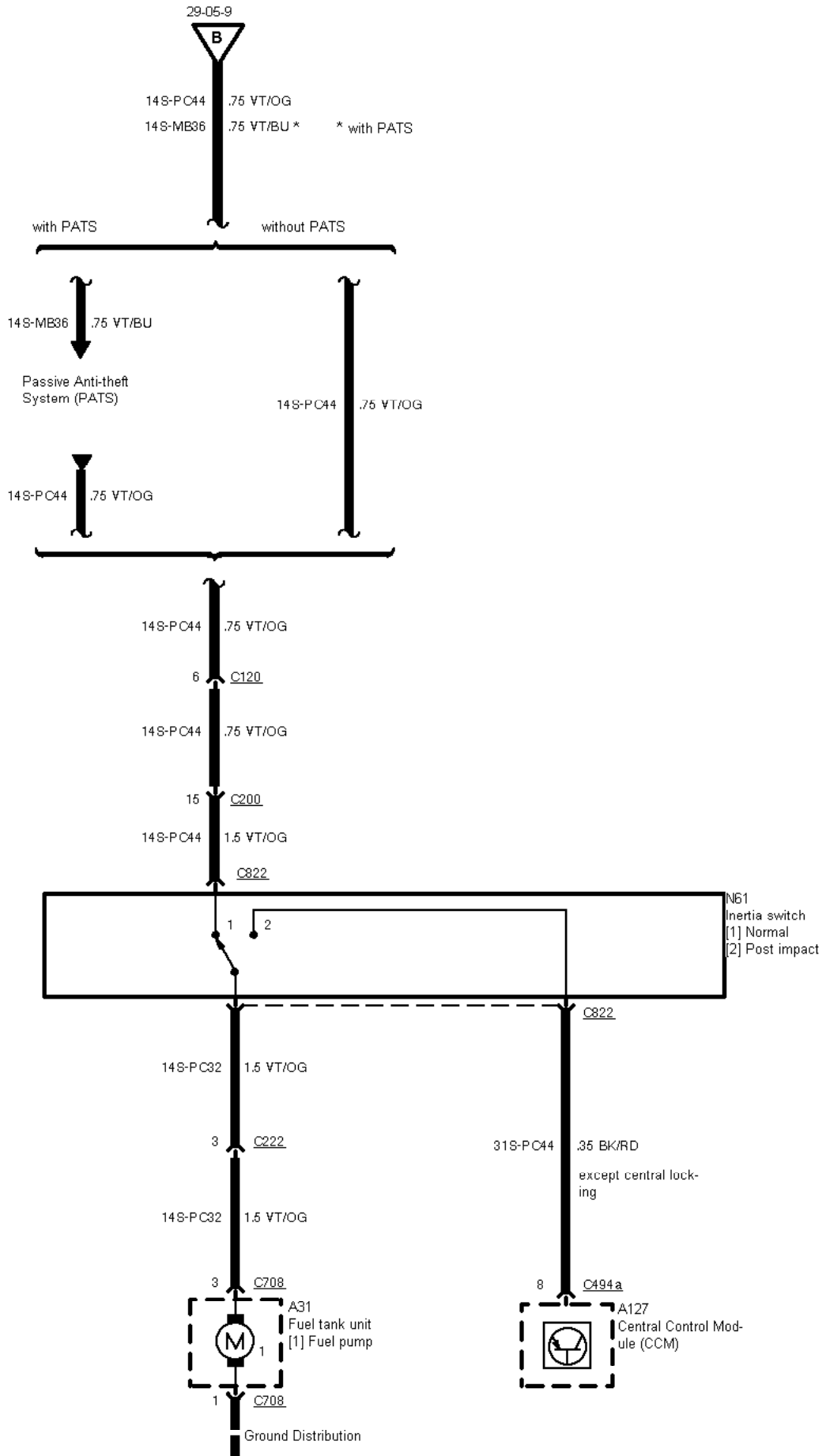



29-05-011 , Engine Control 2,9 I V6 12V EFI

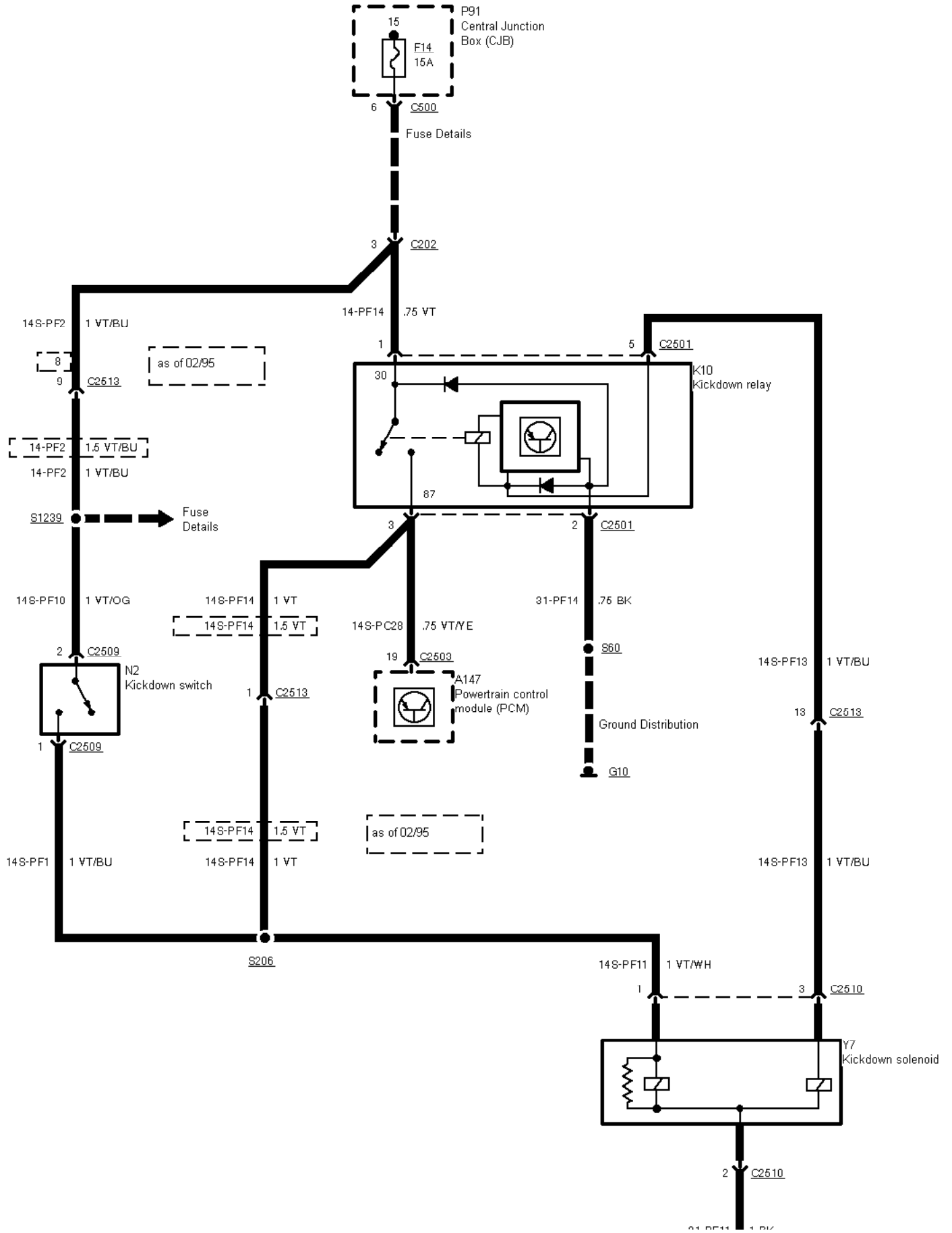

317711 1 BK



G11

29-05-012 , Engine Control 2,9 I V6 12V EFI

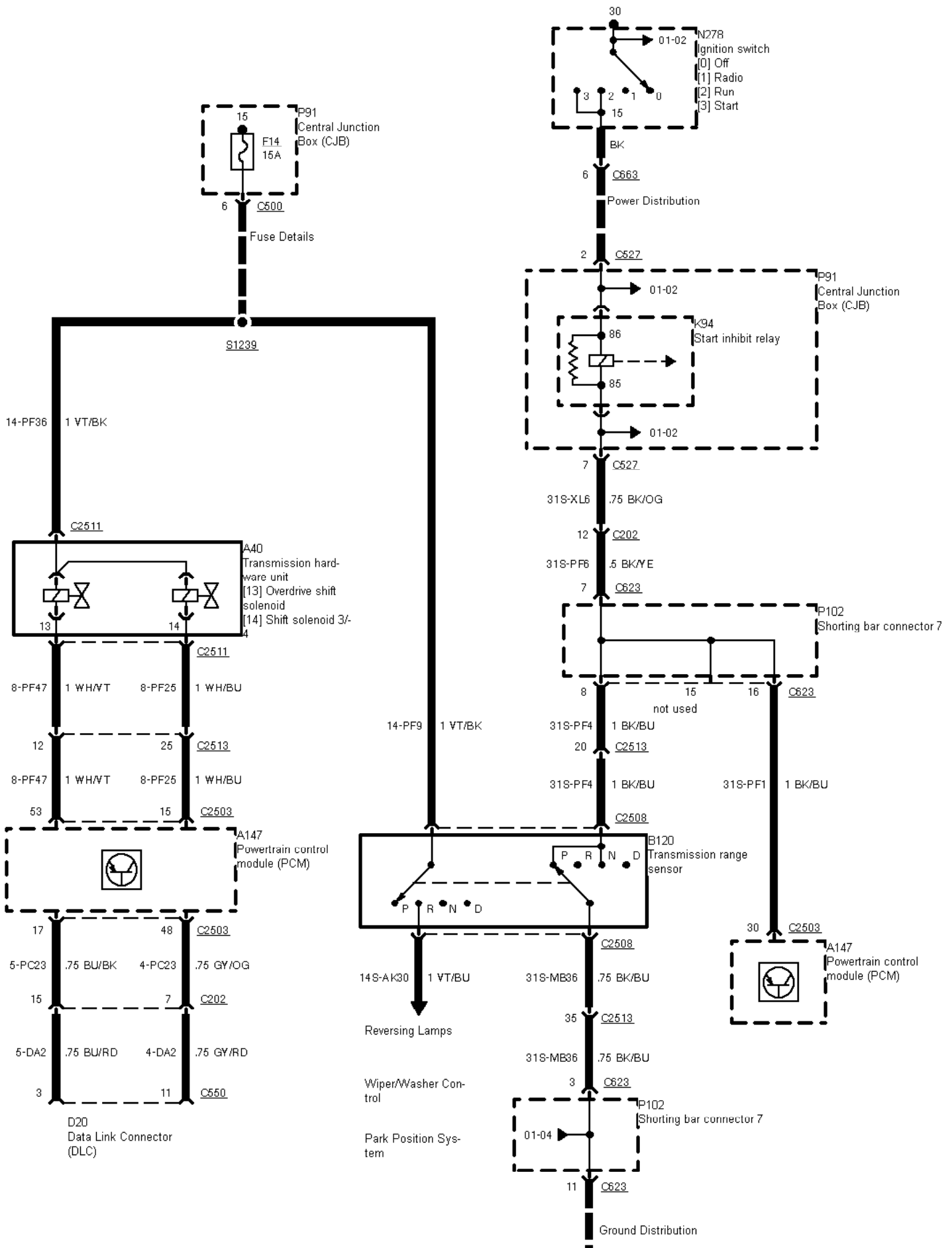

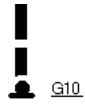

29-05-013 , Engine Control 2,9 I V6 12V EFI

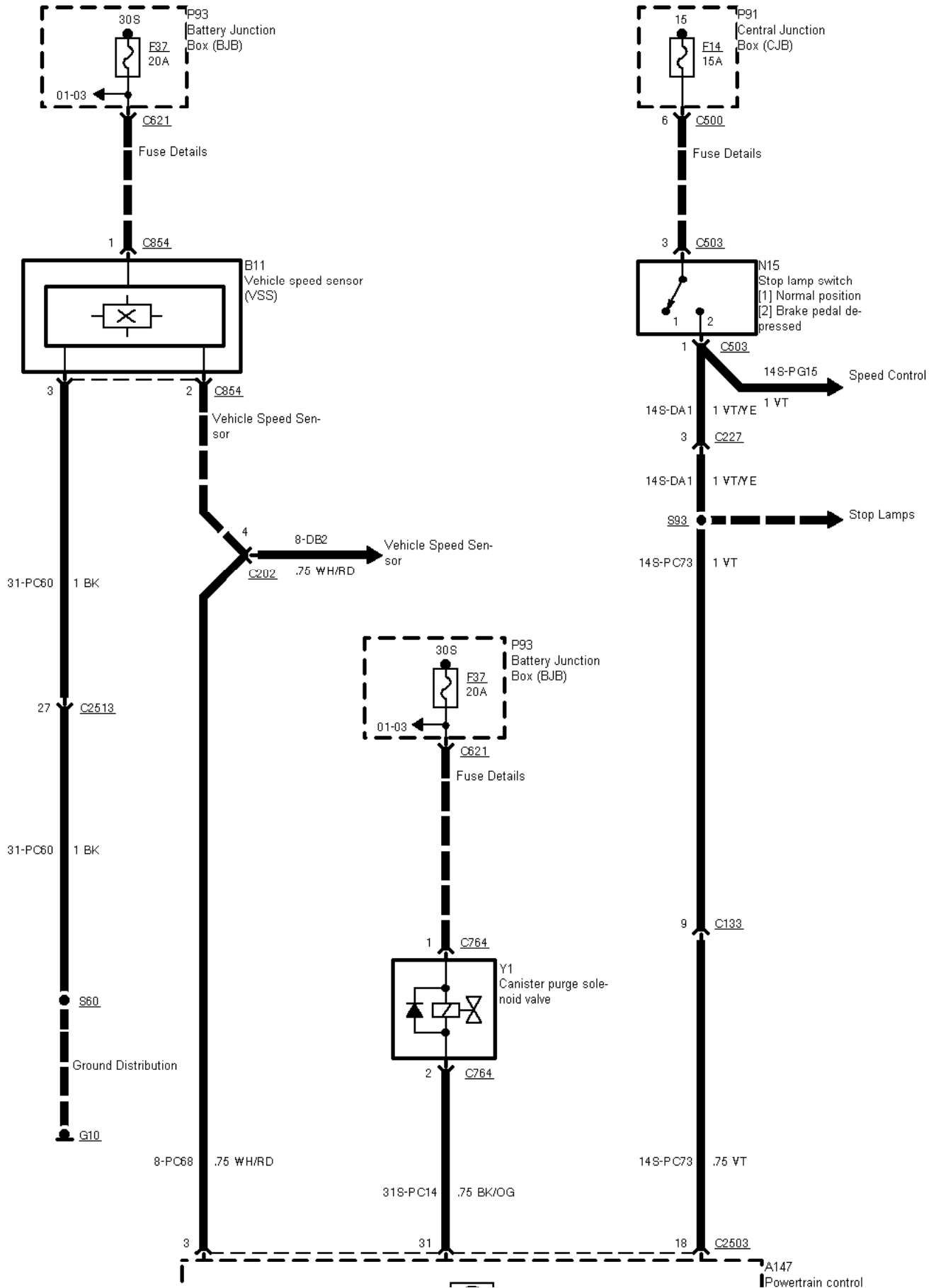



29-05-014 , Engine Control 2,9 I V6 12V EFI

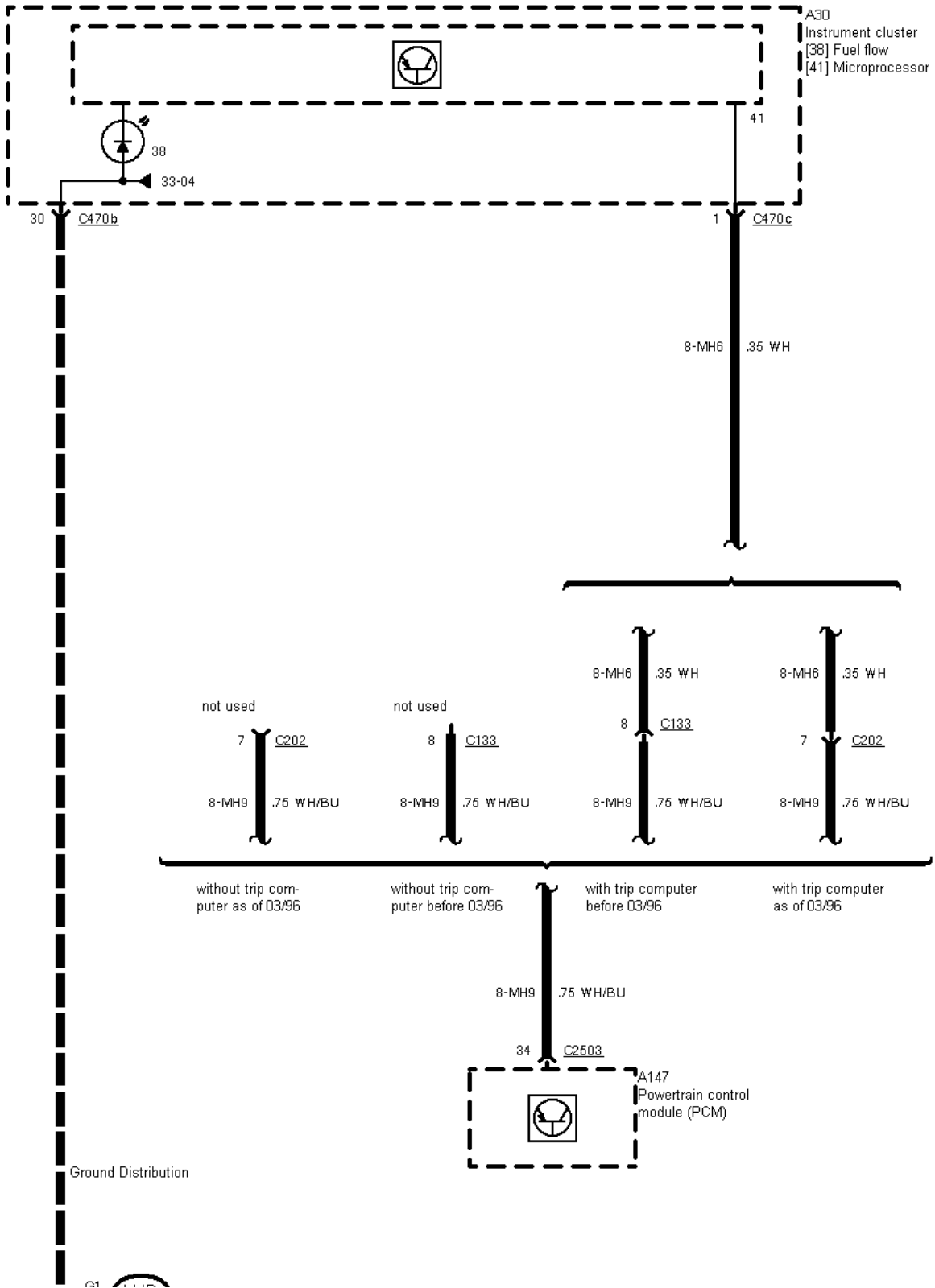

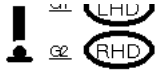

29-05-015 , Engine Control 2,9 I V6 12V EFI , Engine cooling fan

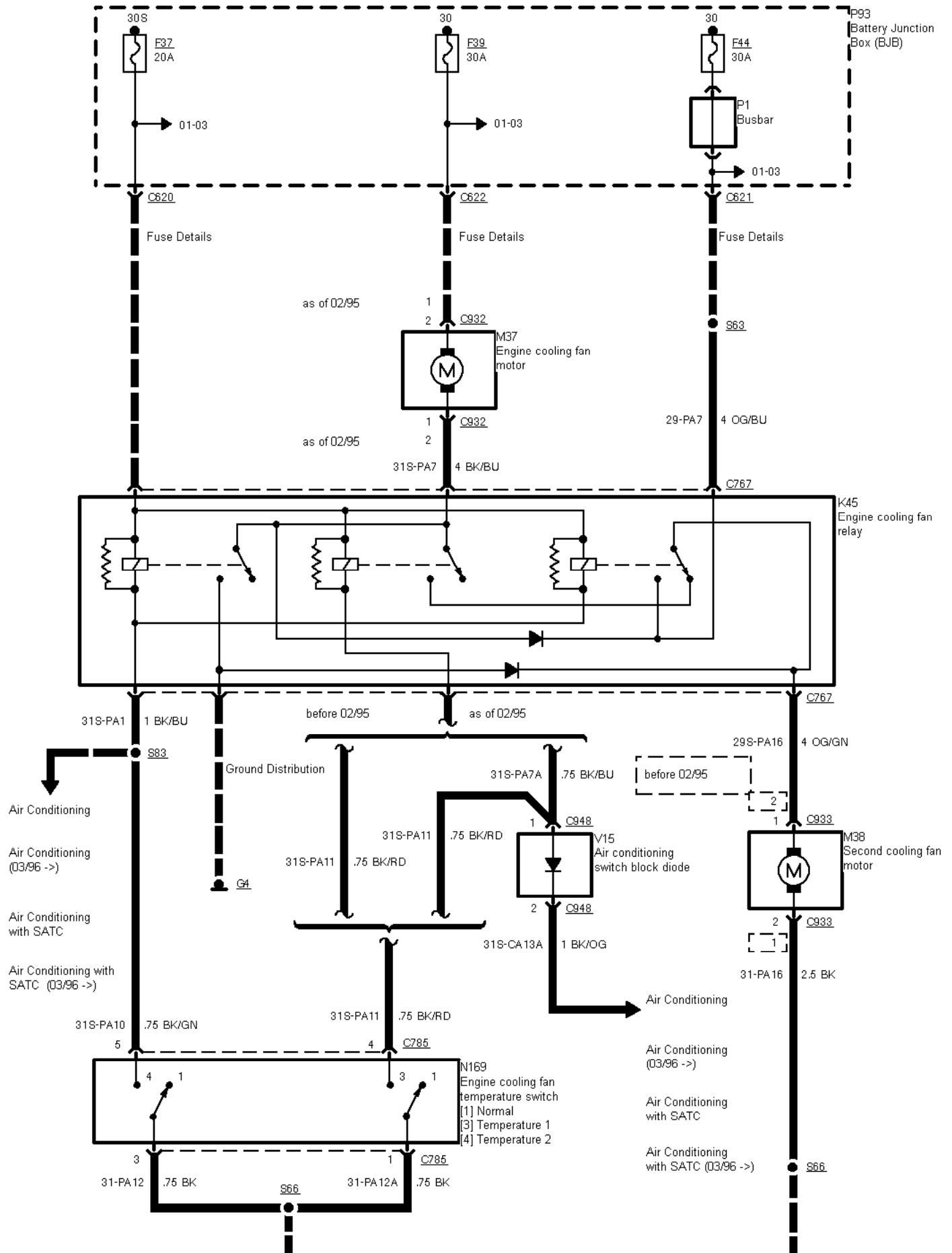

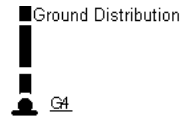
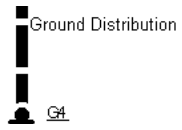

2 Circuit Description
