

Compression – Engine Hot – Check (21 111 0)

Proprietary Tools

Motometer compression pressure recorder no.623.000.1101

Materials

Spark plug thread lubricant
(Never Seez)

ESE-M1244-A

Check the compression pressure

1. General notes.

- Different designs of compression pressure tester and fluctuating starter motor speeds usually only make it possible to check that the compression is equal in all the cylinders.
- The actual compression pressure depends on a number of factors and can only be measured when certain conditions apply.
- The battery must be in good condition and fully charged.
- The engine should be at normal operating temperature.

NOTE: The engine will start, run for a few seconds then stall.

2. Remove the injection pump relay from the auxiliary fuse box.

3. Start the engine.

4. Disconnect the HT leads (right-hand side shown).

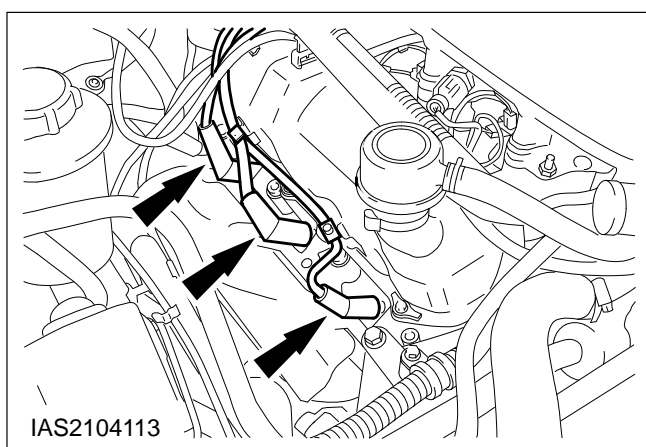
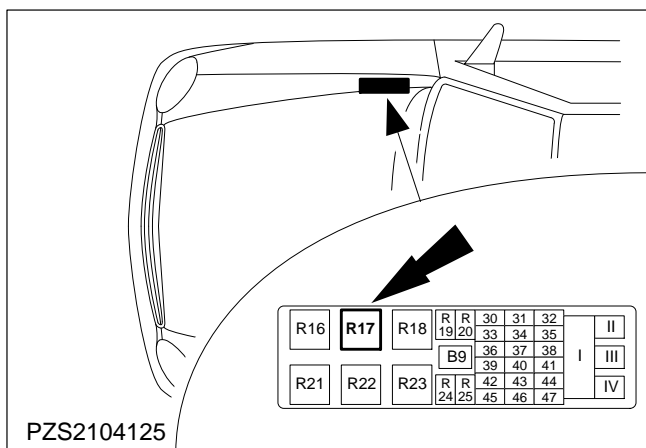

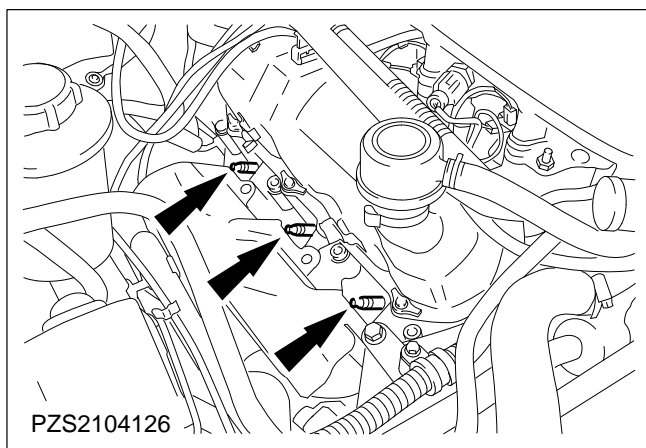

5. Unscrew the spark plugs.

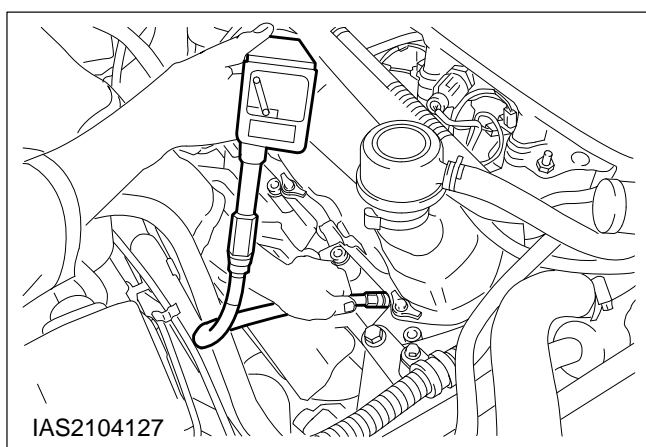

6. Check the compression pressure.

- Set up the gauge.
- Depress the accelerator pedal fully.
- Crank the engine on the starter motor until the needle on the tester does not go up any more.

7. Repeat the checking procedure for the other cylinders.

Compare the values measured with those in the technical data.

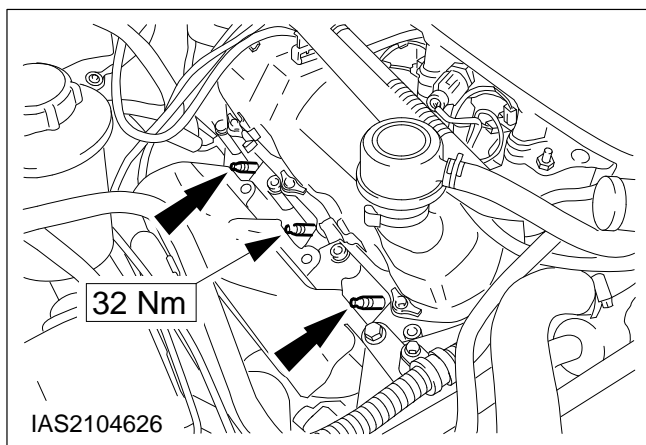

NOTE: Apply lubricant (Never Seez, ESE-M1244-A) to the spark plug threads.

8. Install the spark plugs.

9. Connect the HT leads.

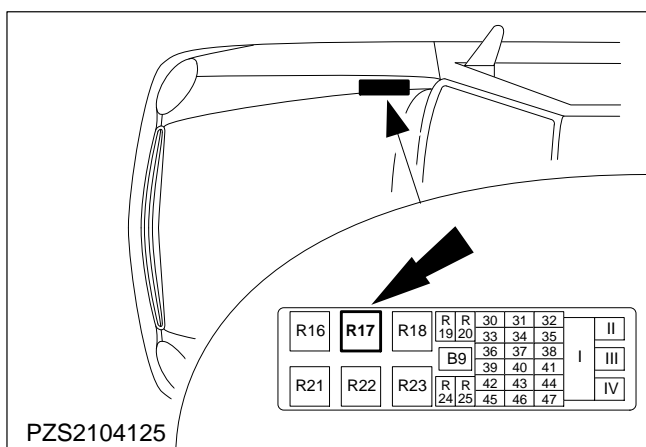

10. Fit the injection pump relay.

11. Finishing operations:

- Check the fluid levels and rectify as necessary.
- Carry out a road test to enable the PCM module to collect data.